

Project:

Fixture Type:

Location:

Contact/Phone:

## PRODUCT DESCRIPTION

4" LED dedicated IC housing, LS-4R-IC-AT-NJ is designed for remodel applications and suitable for use in ceiling where the housing can be direct contact with insulation. Remodel housing install into existing drywall or wood ceiling with no above access. Air tight construction reduces energy costs by reducing the amount of air leakage through the ceiling.

## PRODUCT SPECIFICATIONS

### Junction Box

- Listed for through branch circuit wiring.
- Contains three 1-1/8", five 7/8" knockouts and four Romex pryouts with strain relief.

### Ceiling Thickness

- Housing adjusts from 5/8"-1 3/8" to accommodate various ceiling thickness.

### Remodel Clips

- Three remodel clips secure housing and accommodates 1/2" and 5/8" ceiling materials.

### Listings

- cULus Listed for Damp Location
- cULus Listed for Feed Through
- Certified under ASTM-E283 for Air tight construction

## CONNECTOR

Model NO. LSL-4R-IC-AT-NJ

Triac Dimming version

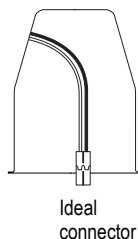

## LS-4R-IC-AT-NJ

4" IC LED Dedicated Can Remodel Housing (New Junctionbox)



## DIMENSIONS

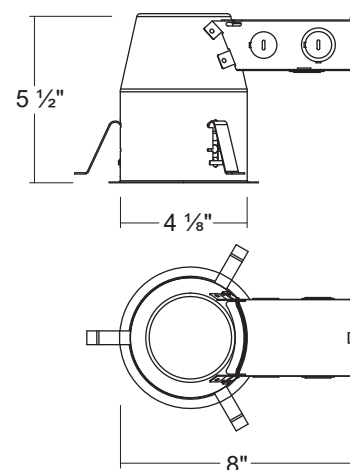

## COMPATIBLE TRIMS

Dimming	Model NO.	Description
Triac Dimming	LSL-400	4" LED Retrofit / Smooth
	LSL-403	4" LED Retrofit / Baffle

## ORDERING INFORMATION

Model NO.	Dimming	Description
LS-4R-IC-AT-NJ	Triac Dimming	4" IC Dedicated Can Remodel Housing (New Junctionbox)