



# LS-ADL6-15W-5CCT

## 6" Selectable 5CCT LED Disk Light

LUMENS: 900lm

COLOR TEMPERATURE: Selectable 5CCT

APERTURE: Round

**Description** 6" selectable 5CCT LED Disk light is compatible with standard J-box or 5" & 6" standard recessed new construction and remodel housings.

### FEATURES

- 900lm / 15W
- Selectable CCT: 2700K, 3000K, 3500K, 4000K, 5000K @ 90+CRI
- Built-in on board driver with 90mA output and 120V AC input
- Flickering free AC design
- High quality aluminum and PC material in White finish
- Compatible with standard octagon junction box
- 5" & 6" Recessed mounting brackets available (sold separately)
- Emergency Backup option available
- Dimming down to 10% with most dimmers
- Certified to the high efficacy requirements of California JA8 Title 24
- cETLus listed for Wet Location
- ENERGY STAR Certified

CCT SELECTABLE SWITCH

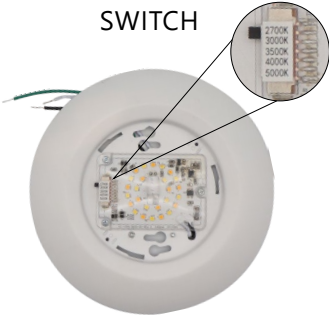

### PRODUCT IMAGES & DIMENSIONS



**LS2-ADL6-15W-5CCT**  
6" Selectable 5CCT LED Disk Light,  
White

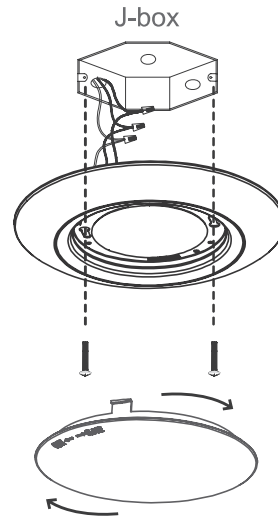
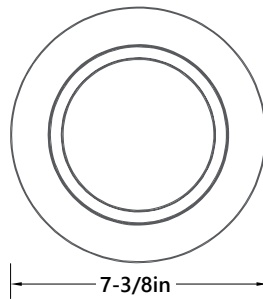

5" & 6" Housing

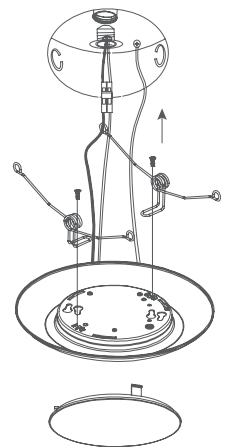

### SPECIFICATIONS

Catalog Number	Size	Type/Finish	Lumen / Wattage	Selectable CCT	CRI	Certificated
LS2-ADL6-15W-5CCT	6"	Slim Round / White	900lm/15W	27K/30K/35K/40K/50K	90+	cETLus

#### OPTIONAL ACCESSORIES

**LSRA-6E26MB** Mounting bracket kit for 5" & 6" recessed housings