



FLUSH MOUNT LED SURFACE LIGHT

5" / 7" / 9" / 12" / 15" Selectable 5CCT, 90+CRI with Triac Dimming

The flush mount surface light series is a versatile lighting solution perfect for various applications. Operating from 9W to 25W and provides a bright range 750-2100 lumen output, making it an energy-efficient replacement for traditional incandescent bulbs. Featuring 5CCT selectable options, this light allows you to customize the ambiance to your preference, from warm to cool tones. Its flush mount design ensures a sleek, low-profile appearance, and its suitability for wet locations makes it ideal for bathrooms, showers, and outdoor covered areas, providing reliable and stylish illumination wherever needed.

FEATURES

- 750lm-2100lm / 9W-25W
- Selectable 2700K, 3000K, 3500K, 4000K or 5000K
- High CRI (90+)
- 120V; Triac Dimming
- Dimming down to 10% with most dimmers
- Flush mounted
- 5-year limited warranty
- cULus Listed for Wet locations



DIMENSION

5"	OD: 5"	D: 4.01"	H: 0.55"
7"	OD: 7"	D: 6.06"	H: 0.55"
9"	OD: 9"	D: 8.07"	H: 0.55"
12"	OD: 11.6"	D: 10.04"	H: 0.87"
15"	OD: 14.3"	D: 12.72"	H: 0.87"

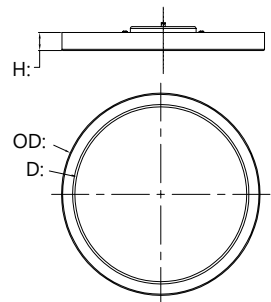

ORDERING INFO

PART NUMBER	SIZE	LUMEN/WATTAGE	SELECTABLE 5CCT	VOLTAGE	DIMMING	CRI	FINISH	LISTING
LS-PR5-9W-5CCT	5"	750lm/9W	27K/30K/35K/40K/50K	120V	TRIAC	90	White	cULus
LS-PR7-14W-5CCT	7"	1200lm/14W	27K/30K/35K/40K/50K	120V	TRIAC	90	White	cULus
LS-PR9-17W-5CCT	9"	1400lm/17W	27K/30K/35K/40K/50K	120V	TRIAC	90	White	cULus
LS-PR12-21W-5CCT	12"	1800lm/21W	27K/30K/35K/40K/50K	120V	TRIAC	90	White	cULus
LS-PR15-25W-5CCT	15"	2100lm/25W	27K/30K/35K/40K/50K	120V	TRIAC	90	White	cULus