



COMMERCIAL OUTDOOR LIGHTING

CYLINDER LED WALL LIGHT

12W & 24W SELECTABLE 5CCT UP & DOWN WALL SCENCE



The LED Wall Fixture is an exceptional lighting solution designed for both functionality and aesthetics, making it ideal for outdoor spaces. Featuring a built-in photocell sensor, this fixture automatically adjusts its brightness based on ambient light, ensuring optimal energy efficiency. With a power output of 24W, it delivers an impressive 2000 lumens of illumination, providing ample brightness for any setting. The fixture boasts 5CCT selectable options, allowing users to choose their preferred color temperature for a customizable ambiance. Rated IP65, it is specifically engineered for wet locations, offering durability and reliability against the elements. Perfect for enhancing the beauty of gardens, corridors, patios, balconies, villas, walkways, and pillars, this LED Wall Fixture combines style with practicality, making outdoor decorating both effortless and elegant.



FEATURES

- (8") 960lm / 12W & (14") 2000lm / 24W
- Selectable 2700K, 3000K, 3500K, 4000K or 5000K
- Die-cast aluminum housing and tempered glass
- Waterproof IP65 design for rain and snow
- 100-277V, 50-60HZ
- Anti-UV, rust & corrosion powder coated black finish
- 3-year limited warranty
- cETLus Listed

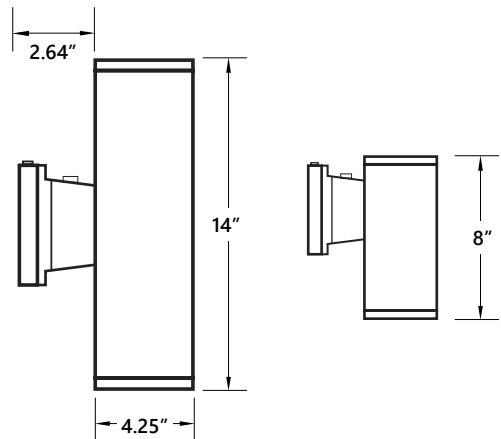

ORDERING INFO

PART NUMBER	SIZE	LUMEN/WATTAGE	SELECTABLE 5CCT	VOLTAGE	DIMMING	CRI	FINISH	LISTING
LS-CUD-8R12W-5CCT	8"	960lm/12W	27K/30K/35K/40K/50K	100-277V	TRIAC	80	Black	cETLus
LS-CUD-14R24W-5CCT	14"	2000lm/24W	27K/30K/35K/40K/50K	100-277V	TRIAC	80	Black	cETLus